

SECTION 2 [Sections 2 through 8 must be completed for each redevelopment project area listed in Section 1.]

FY 2024

Name of Redevelopment Project Area:

Lumber Lane

Primary Use of Redevelopment Project Area*: Commercial	
*Types include: Central Business District, Retail, Other Commercial, Industrial, Residential, and Combination/Mixed.	
If "Combination/Mixed" List Component Types:	
Under which section of the Illinois Municipal Code was the Redevelopment Project Area designated? (check one):	
Tax Increment Allocation Redevelopment Act	<input checked="" type="checkbox"/>
Industrial Jobs Recovery Law	<input type="checkbox"/>

Please utilize the information below to properly label the Attachments.

	No	Yes
For redevelopment projects beginning prior to FY 2022, were there any amendments, to the redevelopment plan, the redevelopment project area, or the State Sales Tax Boundary? [65 ILCS 5/11-74.4-5 (d) (1) and 5/11-74.6-22 (d) (1)] If yes, please enclose the amendment (labeled Attachment A). For redevelopment projects beginning in or after FY 2022, were there any amendments, enactments or extensions to the redevelopment plan, the redevelopment project area, or the State Sales Tax Boundary? [65 ILCS 5/11-74.4-5 (d) (1) and 5/11-74.6-22 (d) (1)] If yes, please enclose the amendment, enactment or extension, and a copy of the redevelopment plan (labeled Attachment A).	X	
Certification of the Chief Executive Officer of the municipality that the municipality has complied with all of the requirements of the Act during the preceding fiscal year. [65 ILCS 5/11-74.4-5 (d) (3) and 5/11-74.6-22 (d) (3)] Please enclose the CEO Certification (labeled Attachment B).		X
Opinion of legal counsel that municipality is in compliance with the Act. [65 ILCS 5/11-74.4-5 (d) (4) and 5/11-74.6-22 (d) (4)] Please enclose the Legal Counsel Opinion (labeled Attachment C).		X
Statement setting forth all activities undertaken in furtherance of the objectives of the redevelopment plan, including any project implemented and a description of the redevelopment activities. [65 ILCS 5/11-74.4-5 (d) (7) (A and B) and 5/11-74.6-22 (d) (7) (A and B)] If yes, please enclose the Activities Statement (labeled Attachment D).		X
Were any agreements entered into by the municipality with regard to the disposition or redevelopment of any property within the redevelopment project area or the area within the State Sales Tax Boundary? [65 ILCS 5/11-74.4-5 (d) (7) (C) and 5/11-74.6-22 (d) (7) (C)] If yes, please enclose the Agreement(s) (labeled Attachment E).	X	
Is there additional information on the use of all funds received under this Division and steps taken by the municipality to achieve the objectives of the redevelopment plan? [65 ILCS 5/11-74.4-5 (d) (7) (D) and 5/11-74.6-22 (d) (7) (D)] If yes, please enclose the Additional Information (labeled Attachment F).	X	
Did the municipality's TIF advisors or consultants enter into contracts with entities or persons that have received or are receiving payments financed by tax increment revenues produced by the same TIF? [65 ILCS 5/11-74.4-5 (d) (7) (E) and 5/11-74.6-22 (d) (7) (E)] If yes, please enclose the contract(s) or description of the contract(s) (labeled Attachment G).	X	
Were there any reports <u>submitted to</u> the municipality <u>by</u> the joint review board? [65 ILCS 5/11-74.4-5 (d) (7) (F) and 5/11-74.6-22 (d) (7) (F)] If yes, please enclose the Joint Review Board Report (labeled Attachment H).	X	
Were any obligations issued by the municipality? [65 ILCS 5/11-74.4-5 (d) (8) (A) and 5/11-74.6-22 (d) (8) (A)] If yes, please enclose any Official Statement (labeled Attachment I). If Attachment I is answered yes, then the Analysis must be attached (labeled Attachment J).	X	
An analysis prepared by a financial advisor or underwriter, chosen by the municipality, setting forth the nature and term of obligation; projected debt service including required reserves and debt coverage; and actual debt service. [65 ILCS 5/11-74.4-5 (d) (8) (B) and 5/11-74.6-22 (d) (8) (B)] If attachment I is yes, the Analysis and an accompanying letter from the municipality outlining the contractual relationship between the municipality and the financial advisor/underwriter <u>MUST</u> be attached (labeled Attachment J).	X	
Has a cumulative of \$100,000 of TIF revenue been deposited into the special tax allocation fund? 65 ILCS 5/11-74.4-5 (d) (2) and 5/11-74.6-22 (d) (2) If yes, please enclose audited financial statements of the special tax allocation fund (labeled Attachment K).	X	
Cumulatively, have deposits of incremental taxes revenue equal to or greater than \$100,000 been made into the special tax allocation fund? [65 ILCS 5/11-74.4-5 (d) (9) and 5/11-74.6-22 (d) (9)] If yes, the audit report shall contain a letter from the independent certified public accountant indicating compliance or noncompliance with the requirements of subsection (q) of Section 11-74.4-3 (labeled Attachment L).	X	
A list of all intergovernmental agreements in effect to which the municipality is a part, and an accounting of any money transferred or received by the municipality during that fiscal year pursuant to those intergovernmental agreements. [65 ILCS 5/11-74.4-5 (d) (10)] If yes, please enclose the list only, not actual agreements (labeled Attachment M).	X	
For redevelopment projects beginning in or after FY 2022, did the developer identify to the municipality a stated rate of return for each redevelopment project area? Stated rates of return required to be reported shall be independently verified by a third party chosen by the municipality. If yes, please enclose evidence of third party verification, may be in the form of a letter from the third party (labeled Attachment N).	X	

SECTION 3.1 [65 ILCS 5/11-74.4-5 (d)(5)(a)(b)(d)) and (65 ILCS 5/11-74.6-22 (d) (5)(a)(b)(d)]

FY 2024

Name of Redevelopment Project Area:

Lumber Lane

Provide an analysis of the special tax allocation fund.

Special Tax Allocation Fund Balance at Beginning of Reporting Period \$ 16,830

SOURCE of Revenue/Cash Receipts:	Revenue/Cash Receipts for Current Reporting Year	Cumulative Totals of Revenue/Cash Receipts for life of TIF	% of Total
Property Tax Increment	\$ 10,099	\$ 26,800	98%
State Sales Tax Increment			0%
Local Sales Tax Increment			0%
State Utility Tax Increment			0%
Local Utility Tax Increment			0%
Interest	\$ 444	\$ 573	2%
Land/Building Sale Proceeds			0%
Bond Proceeds			0%
Transfers from Municipal Sources			0%
Private Sources			0%
Other (identify source _____; if multiple other sources, attach schedule)			0%

All Amount Deposited in Special Tax Allocation Fund \$ 10,543

Cumulative Total Revenues/Cash Receipts \$ 27,373 100%

Total Expenditures/Cash Disbursements (Carried forward from Section 3.2) \$ -

Transfers to Municipal Sources

Distribution of Surplus

Total Expenditures/Disbursements \$ -

Net/Income/Cash Receipts Over/(Under) Cash Disbursements \$ 10,543

Previous Year Adjustment (Explain Below)

FUND BALANCE, END OF REPORTING PERIOD* \$ 27,373

* If there is a positive fund balance at the end of the reporting period, you must complete Section 3.3

Previous Year Explanation:

		\$ -
9. Financing costs.		
		\$ -
10. Capital costs.		
		\$ -
11. Cost of reimbursing school districts for their increased costs caused by TIF assisted housing projects.		
		\$ -
12. Cost of reimbursing library districts for their increased costs caused by TIF assisted housing projects.		
		\$ -

**SECTION 3.2 A
PAGE 3**

13. Relocation costs.		
		\$ -
14. Payments in lieu of taxes.		
		\$ -
15. Costs of job training, retraining, advanced vocational or career education.		
		\$ -
16. Interest cost incurred by redeveloper or other nongovernmental persons in connection with a redevelopment project.		

		\$ -
17. Cost of day care services.		
		\$ -
18. Other.		
		\$ -
TOTAL ITEMIZED EXPENDITURES		\$ -

SECTION 3.3 [65 ILCS 5/11-74.4-5 (d) (5d) 65 ILCS 5/11-74.6-22 (d) (5d)]

FY 2024

Name of Redevelopment Project Area:

Lumber Lane

Breakdown of the Balance in the Special Tax Allocation Fund At the End of the Reporting Period by source

FUND BALANCE BY SOURCE	\$ 27,373
------------------------	-----------

1. Description of Debt Obligations	Amount of Original Issuance	Amount Designated
Total Amount Designated for Obligations	\$ -	\$ -

2. Description of Project Costs to be Paid	Amount of Original Issuance	Amount Designated
Project reimbursement		\$ 27,373
Total Amount Designated for Project Costs		\$ 27,373

TOTAL AMOUNT DESIGNATED	\$ 27,373
-------------------------	-----------

SURPLUS/(DEFICIT)	\$ (0)
-------------------	--------

SECTION 4 [65 ILCS 5/11-74.4-5 (d) (6) and 65 ILCS 5/11-74.6-22 (d) (6)]

FY 2024

Name of Redevelopment Project Area:

Lumber Lane

Provide a description of all property purchased by the municipality during the reporting fiscal year within the redevelopment project area.

X	Indicate an 'X' if no property was acquired by the municipality within the redevelopment project area.
----------	---

Property (1):	
Street address:	
Approximate size or description of property:	
Purchase price:	
Seller of property:	

Property (2):	
Street address:	
Approximate size or description of property:	
Purchase price:	
Seller of property:	

Property (3):	
Street address:	
Approximate size or description of property:	
Purchase price:	
Seller of property:	

Property (4):	
Street address:	
Approximate size or description of property:	
Purchase price:	
Seller of property:	

Property (5):	
Street address:	
Approximate size or description of property:	
Purchase price:	
Seller of property:	

Property (6):	
Street address:	
Approximate size or description of property:	
Purchase price:	
Seller of property:	

Property (7):	
Street address:	
Approximate size or description of property:	
Purchase price:	
Seller of property:	

SECTION 5 [20 ILCS 620/4.7 (7)(F)]

FY 2024

Name of Redevelopment Project Area:

Lumber Lane

PAGE 1

Page 1 MUST be included with TIF report. Pages 2 and 3 are to be included ONLY if projects are listed.

Select ONE of the following by indicating an 'X':

1. NO projects were undertaken by the Municipality Within the Redevelopment Project Area.	
2. The municipality DID undertake projects within the Redevelopment Project Area. (If selecting this option, complete 2a and 2b.)	X
2a. The total number of ALL activities undertaken in furtherance of the objectives of the redevelopment plan:	1
2b. Did the municipality undertake any NEW projects in fiscal year 2022 or any fiscal year thereafter within the Redevelopment Project Area?	0

LIST ALL projects undertaken by the Municipality Within the Redevelopment Project Area:

	11/1/99 to Date	Estimated Investment for Subsequent Fiscal Year	Total Estimated to Complete Project
TOTAL:			
Private Investment Undertaken (See Instructions)	\$ -	\$ -	\$ -
Public Investment Undertaken	\$ 1,043,286	\$ 27,374	\$ 1,043,286
Ratio of Private/Public Investment	0		0

Project 1 Name: Lumber Lane Development

Private Investment Undertaken (See Instructions)			
Public Investment Undertaken	\$ 1,043,286	\$ 27,374	\$ 1,043,286
Ratio of Private/Public Investment	0		0

Project 2 Name:

Private Investment Undertaken (See Instructions)			
Public Investment Undertaken			
Ratio of Private/Public Investment	0		0

Project 3 Name:

Private Investment Undertaken (See Instructions)			
Public Investment Undertaken			
Ratio of Private/Public Investment	0		0

Project 4 Name:

Private Investment Undertaken (See Instructions)			
Public Investment Undertaken			
Ratio of Private/Public Investment	0		0

Project 5 Name:

Private Investment Undertaken (See Instructions)			
Public Investment Undertaken			
Ratio of Private/Public Investment	0		0

Project 6 Name:

Private Investment Undertaken (See Instructions)			
Public Investment Undertaken			
Ratio of Private/Public Investment	0		0

SECTION 6 [Information requested in SECTION 6.1 is not required by law, but may be helpful in evaluating the performance of TIF in Illinois. SECTIONS 6.2, 6.3, and 6.4 are required by law, if applicable. (65 ILCS 5/11-74.4-5(d))]

FY 2024

Name of Redevelopment Project Area:

Lumber Lane

SECTION 6.1-For redevelopment projects beginning before FY 2022, complete the following information about job creation and retention.

Number of Jobs Retained	Number of Jobs Created	Job Description and Type (Temporary or Permanent)	Total Salaries Paid
			\$ -

SECTION 6.2-For redevelopment projects beginning in or after FY 2022, complete the following information about projected job creation and actual job creation.

Project Name	The number of jobs, if any, projected to be created at the time of approval of the redevelopment agreement.		The number of jobs, if any, created as a result of the development to date, for the reporting period, under the same guidelines and assumptions as was used for the projections used at the time of approval of the redevelopment agreement.	
	Temporary	Permanent	Temporary	Permanent

SECTION 6.3-For redevelopment projects beginning in or after FY 2022, complete the following information about increment projected to be created and actual increment created.

Project Name	The amount of increment projected to be created at the time of approval of the redevelopment agreement.	The amount of increment created as a result of the development to date, for the reporting period, using the same assumptions as was used for the projections used at the time of the approval of the redevelopment agreement.

SECTION 6.4-For redevelopment projects beginning in or after FY 2022, provide the stated rate of return identified by the developer to the municipality and verified by an independent third party, IF ANY:

Project Name	Stated Rate of Return

SECTION 7 [Information in the following section is not required by law, but may be helpful in evaluating the performance of TIF in Illinois.]

FY 2024

Name of Redevelopment Project Area:

Lumber Lane

Provide a general description of the redevelopment project area using only major boundaries.

See attached Legal Description and Map

Optional Documents	Enclosed
Legal description of redevelopment project area	Yes
Map of District	Yes

EXHIBIT A**Legal Description**
Revised Lumber Lane Redevelopment Project Area

Part of the Northeast Quarter of the Northwest Quarter of Section 19, Township 16 North, Range 4 West of the Third Principal Meridian, Sangamon County, Illinois described as follows:

Commencing at the intersection of the East line of Quarter Section and the South Right-of-Way line of Illinois SA Route 3 thence West on aforesaid Right-of-Way line, 212.39 feet; thence deflecting to the right 00 degrees 39 minutes 20 seconds on said Right-of-Way line, 87.61 feet to the point of beginning; thence deflecting to the Left 90 degrees 52 minutes 00 seconds, 794.26 feet; thence deflecting to the right 71 degrees 49 minutes 50 seconds, 109.56 feet to the point of curve of a 60.00 foot radius curve to the right; thence northwesterly on said curve for a chord distance of 58.53 feet; thence deflecting to the right from the chord of said curve 29 degrees 11 minutes 31 seconds, 288.68 feet to the point of curve of a 20.00 foot radius curve to the right; thence northwesterly on said curve a chord distance of 17.32 feet to the point of curve of a 60.00 foot radius curve to the left; thence northwesterly on aforesaid curve a chord distance of 37.70 feet; thence North parallel to the first described line 585.00 feet to the South Right-of-Way line of SA Route 3; thence East on said Right-of-Way line to the point of beginning.

ALSO, all that part of Lumber Lane described as follows:

Beginning at the intersection of the northerly Right-of-Way line of Lumber lane and the East line of the above described parcel; thence 109.56 feet along said northerly Right-of-Way line to the point of curve of a 60.00 foot radius curve to the right; thence northwesterly to the point of curve of a 60.00 foot radius curve to the left, thence northwesterly on said curve for a chord distance of 58.33 feet; thence deflecting to the right from said chord 29 degrees 11 minutes 31 seconds, 278.50 feet to the point of curve of a 60.00 foot radius curve to the left; ; thence northwesterly on said curve for a chord distance of 83.46 feet; thence southerly and southeasterly on said curve for a chord distance of 119.30 feet to a point on a 20.00 foot radius reverse curve to the right; thence southeasterly on said curve for a chord distance of 26.45 feet; thence southeasterly on the southerly Right-of-Way line of Lumber lane, 198.55 feet to the point of curve of a 120.00 foot radius curve to the left; thence southeasterly on said curve for a chord distance of 116.98 feet to the intersection of said curve and the northerly Right-of-Way line of the Norfolk and Southern Railroad; thence northeasterly along said Railroad Right-of-Way line to the intersection with an extension of East line of the above described property; thence North along said extension of the East property line to the point of beginning.

The above described parcel contains a total of 7.777 acres, more or less.

4 2 6 - 1 0 - 1 8

Economic and Community Development Commission

City of Springfield, IL

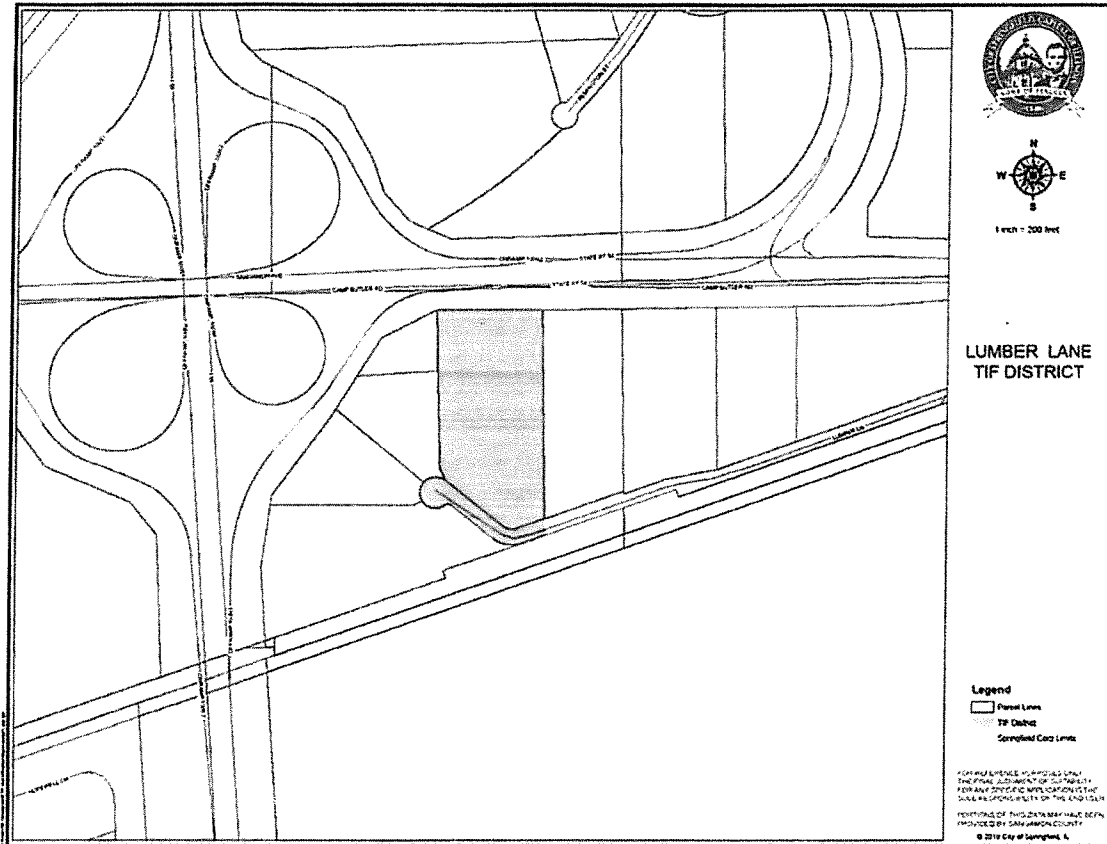

Attachment B



Office of the Mayor
City of Springfield, Illinois
Misty Buscher
Mayor

October 30, 2024

Ms. Susana A. Mendoza
Comptroller, State of Illinois
Office of the Comptroller
100 W. Randolph, Suite 15-500
Chicago, IL 60601

Dear Ms. Mendoza,

In my capacity as Mayor of the City of Springfield, an Illinois Municipal Corporation, I, Misty Buscher certify that in the preceding fiscal year, the City of Springfield, Illinois has complied with all requirements of the Tax Increment Allocation Redevelopment Act [65 ILCS 5/11-74.1 et seq., as amended] as it applied to the following Tax Increment Financing Districts of Springfield, Illinois: Central Area (Downtown), Far East, Enos Park, SHA (Madison Park Place), Northeast, Jefferson Crossing MacArthur Boulevard Corridor, Dirksen Parkway Commercial, Peoria Road, Lumber Lane and Adirondack.

Sincerely,

Misty Buscher
Mayor

Attachment C



Rm. 313 Municipal Center East
800 East Monroe Street
Springfield, IL 62701-1689

Sr. Assistant Corporation Counsel
Steven C. Rahn
Kateah McMasters
Charles Munson
Michael Hampleman

**OFFICE OF CORPORATION COUNSEL
CITY OF SPRINGFIELD, ILLINOIS**

Phone: (217) 789-2393
Fax: (217) 789-2397

GREGORY E. MOREDOCK
Corporation Counsel

Assistant Corporation Counsel
Emily Rosenberger

October 30, 2024

Ms. Susana A. Mendoza
Comptroller, State of Illinois
Office of the Comptroller
100 W. Randolph, Suite 15-500
Chicago, IL 60601

Re: City of Springfield TIF Certification

Dear Ms. Mendoza,

In my capacity as legal counsel for the City of Springfield, I have reviewed the procedures of the City in relation to the requirement of the Public Act [65 ILCS 5/11-74.4-5 (d) (4) and 5/11-74.6-22 (d) (4)]. In my opinion, the City of Springfield is in compliance with the Tax Increment Allocation Redevelopment Act [65 ILCS 5/11-74.1 *et seq.*], for each redevelopment project area in the City, namely, the Central Area (Downtown), Far East, Enos Park, SHA (Madison Park Place), Northeast, Jefferson Crossing MacArthur Boulevard Corridor, Dirksen Parkway Commercial, Peoria Road, Lumber Lane and Adirondack Tax Increment Finance Districts.

Yours truly,

Gregory E. Moredock
Corporation Counsel

Attachment D

ATTACHMENT D

CENTRAL AREA (DOWNTOWN)

Statement setting forth activities: The city provided **\$1,400,000.00** to the Sangamon County Treasurer in property tax rebate, **\$187,380.00** to Acree Company LLC for renovation to create 9 residential units above a commercial storefront, **\$100,000.00** to Vegas Line Properties LLC for façade rehabilitation and easement, **\$100,000.00** to Dog Eared LLC for façade rehabilitation, **\$194,162.18** for staff salary & fringes, **\$26,746.00** to Bloom Springfield LLC for a fire sprinkler system and plumbing work for building code compliance and **\$5,255.92** in miscellaneous costs.

FAR EAST

Statement setting forth activities: The City of Springfield provided **\$171,769.14** for various business rehabilitation and operation grants, **\$90,560.97** for home owner rehabilitation grants, **\$1,000,000.00** for demolition related to the large scale low income Poplar Place redevelopment project, **\$7,212.16** for staff salary and fringes and **\$180.00** for recording fees.

ENOS PARK

Statement setting forth activities: The City of Springfield provided, **\$28,387.50** in various homeowner exterior rehab projects, \$27,750 in land purchases, **\$404,014.00** to the Springfield Park District and lighting and landscape improvements, **\$200,000.00** to WRS Legacy LLC for redevelopment and **\$6,594.73** in staff salary & fringes.

SHA (MADISON PARK PLACE)

Statement setting forth activities: The City of Springfield provided **\$337.50** to TIF consultant for work related to project planning, **\$251,026.00** to the Springfield Park District for lighting improvements, **\$244.10** for a legal notice and **\$7,622.73** in staff salary & fringes.

MACARTHUR BOULEVARD CORRIDOR

Statement setting forth activities: The City of Springfield provided **\$123,277.02** to Hy-Vee, Inc. for redevelopment.

DIRKSEN PARKWAY COMMERCIAL

Statement setting forth activities: There was \$130.12 in postage charges for this tax increment district.

NORTHEAST

Statement setting forth activities: The City of Springfield provided **\$236,050.46** to Sangamon County for TIF surplus payment.

PEORIA ROAD

Statement setting forth activities: There was no activity in this tax increment district.

LUMBER LANE

Statement setting forth activities: There was no activity in this tax increment district.

ADIRONDACK

Statement setting forth activities: There was no activity in this tax increment district.

Attachment K

CITY OF SPRINGFIELD, ILLINOIS

**Lumber Lane TIF Redevelopment - Special Revenue Fund
 Schedule of Revenues, Expenditures and Changes in Fund Balance - Budget and Actual
 For the Fiscal Year Ended February 29, 2024**

	Original Budget	Final Budget	Actual	Variance with Final Budget
Revenues				
Taxes				
Property Taxes	\$ 8,000	8,000	10,099	2,099
Investment Income	100	100	444	344
Total Revenues	<u>8,100</u>	<u>8,100</u>	10,543	2,443
Expenditures				
Economic Development				
Contractual Services	—	—	—	—
Net Change in Fund Balance	<u>8,100</u>	<u>8,100</u>	10,543	<u>2,443</u>
Fund Balance - Beginning			<u>16,830</u>	
Fund Balance - Ending			<u>27,373</u>	

Attachment L



**INDEPENDENT AUDITORS' REPORT
ON COMPLIANCE**

October 25, 2024

The Honorable City Mayor
Members of the City Council
City of Springfield, Illinois

We have audited the financial statements of the governmental activities, the business-type activities, each major fund, and the aggregate remaining fund information of the City of Springfield, Illinois, as of and for the year ended February 29, 2024, and have issued our report thereon dated October 25, 2024. We conducted our audit in accordance with auditing standards generally accepted in the United States of America.

Compliance with laws, regulations, contracts, and grants applicable to tax increment financing districts is the responsibility of the City of Springfield, Illinois' management. In connection with our audit, nothing came to our attention that caused us to believe that the City failed to comply with provisions of Subsection (q) of Section 11-74.4-3 of Public Act 85-1142, "An Act in Relation to Tax Increment Financing," insofar as it relates to accounting matters for the Central Area (Downtown) Tax Increment Financing District, the Dirksen Parkway Commercial Tax Increment Financing District, the ENOS Park Neighborhood Tax Increment Financing District, the Far East Side Tax Increment Financing District, the MacArthur Boulevard Corridor Tax Increment Financing District, the Northeast Tax Increment Financing District, the SHA (Madison Park Place) Tax Increment Financing District, the Lumber Lane Tax Increment Financing District, and the Peoria Road Redevelopment Area Tax Increment Financing District, however, our audit was not directed primarily toward obtaining knowledge of such noncompliance. Accordingly, had we performed additional procedures, other matters may have come to our attention regarding the City noncompliance with the above-referenced statute, insofar as it relates to accounting matters.

This report is intended solely for the information and use of the City Council, management, the State of Illinois, and others within the City and is not intended to be, and should not be, used by anyone other than the specified parties.

Cordially,

Lauterbach & Amen, LLP

LAUTERBACH & AMEN, LLP